

PIN CONNECTION

NO	SYMBOL
1	VDD
2	VSS
3	DB7(SI)
4	DB6(SCL)
5	CS
6	RS

TABLE1

MODE	R	F	T
Y	POSITIVE REFLECTIVE YELLOW-GREEN STN TYPE	POSITIVE TRANSPARENT YELLOW-GREEN STN TYPE	POSITIVE TRANSMISSIVE YELLOW-GREEN STN TYPE
G	POSITIVE REFLECTIVE GRAY STN TYPE	POSITIVE TRANSPARENT GRAY STN TYPE	POSITIVE TRANSMISSIVE GRAY STN TYPE
B	POSITIVE REFLECTIVE NEGATIVE TRANSPARENT BLUE STN TYPE	POSITIVE TRANSPARENT NEGATIVE TRANSPARENT BLUE STN TYPE	POSITIVE TRANSMISSIVE NEGATIVE TRANSMISSIVE BLUE STN TYPE
F	POSITIVE REFLECTIVE FSTN TYPE	POSITIVE TRANSPARENT FSTN TYPE	POSITIVE TRANSMISSIVE FSTN TYPE
W	POSITIVE REFLECTIVE BLACK-WHITE STN	POSITIVE TRANSPARENT BLACK-WHITE STN	POSITIVE TRANSMISSIVE BLACK-WHITE STN

PIXEL DETAILS

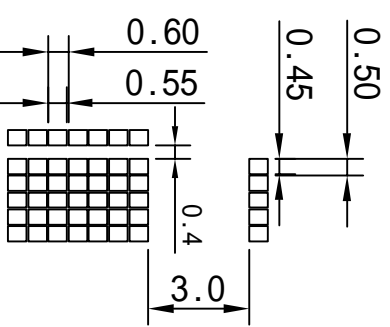

PIN	TYPE	PIN	TYPE
XRESET	1	EXT	0
OSC1	OPEN	CLS	1
OSC2	OPEN	CAP1N	OPEN
RW	1	V0	1
E	1	V1	OPEN
DB0-DB5	1	V2	OPEN
OPF1	0	V3	OPEN
OPF2	1	V4	OPEN
OPR1	0	TEST5	OPEN
OPR2	0	TEST3	OPEN
SHLC	0	VOUT	OPEN
SHLS	1	PSB	0
VIN	1	TEST4	1
TEST1	1	CAP1P	OPEN
TEST2	1		

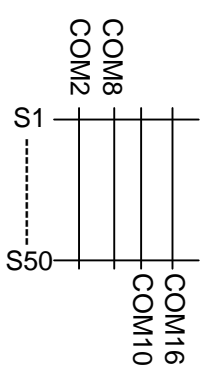

LCD LAYOUT

- NOTE:
- VIEWING ANGLE: 6:00 O' CLOCK
 - DISPLAY MODE: AS IS SHOWN IN TABLE1
 - DRIVING VOLTAGE: 5.0V, DUTY: 1/16, BIAS: 1/5, FREQUENCY: 64KHz, VDD: 5.0V
 - OPERATING TEMP.: -20° C TO 70° C
 - STORAGE TEMP.: -30° C TO 80° C
 - CONNECTOR: COG+PIN TYPE

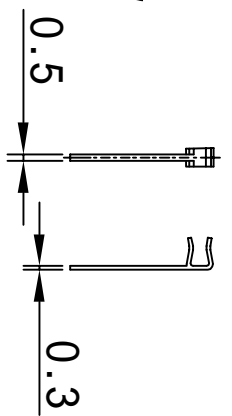

VER.	MODIFY CONTENTS	DATE	DESIGN
1	MODIFY TEMP	2006/01/20	DESIGNER
2			
3			
4			
5			
6			

XIAMEN OCULAR LCD DISPLAY DEVICES CO., LTD